

## CAST LED Engineered Wall Light Product Information

### Surface Mount (CEWL6LED1)

**The CAST LED Engineered Wall Light – Compact, Rugged, Versatile, & Energy Efficient**  
**“The Industry’s only Luminaire that Lasts Longer than its LED Light Source!”**

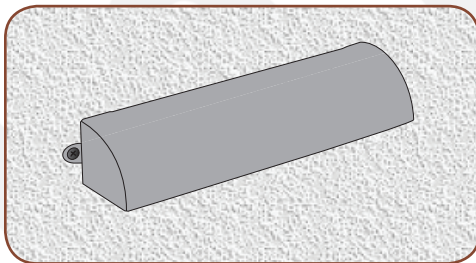
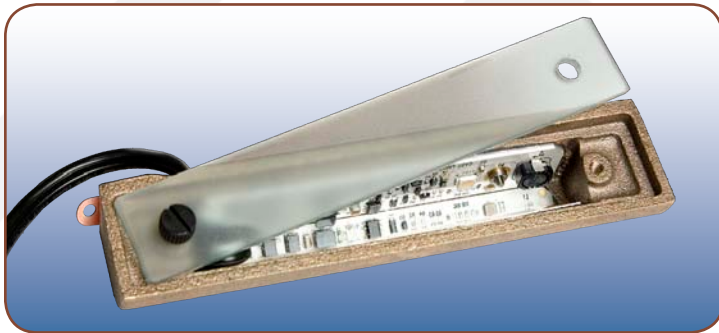
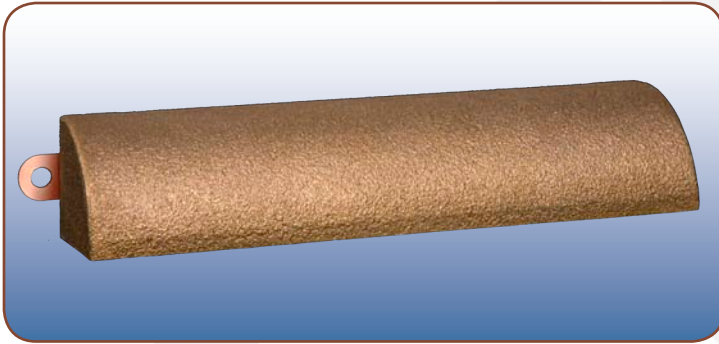

Rock-solid construction with a water-resistant 50,000-hr LED light source.

Typical mounting application on wall.

#### Construction:

Solid bronze body, copper bracket, frosted soda lime lens, stainless steel thumbscrews, high temperature socket, 25' tin-coated #18-2 No-Ox<sup>®</sup> marine-grade wire.

#### Specifications:

Integrated replaceable LED light source (50,000 hr. life). Power consumption – 3W (light output greater than 18W incandescent version of this fixture). Color Temperature: 2700° K; CRI: 85. Accepts input from 8V to 18V (AC or DC). Water resistant.

#### Warranty:

Lifetime on fixture components; 5-Year on LED board and driver.

#### Description:

Attractive LED wall light constructed of solid bronze with a tabbed copper bracket for easy flush mounting walls and railings.

#### Features:

- ▶ Solid bronze construction, highly corrosion resistant, naturally weathers to a beautiful patina.
- ▶ Solid copper bracket for quick installation in a variety of locations.
- ▶ Enclosed LED housing includes internal reflector and frosted glass lens for wide even light distribution (no hot spots) and protection from sprinklers and rain.
- ▶ Replaceable LED board.
- ▶ Pre-wired with 25' tin-coated No-Ox<sup>®</sup> marine grade wire.
- ▶ 50,000 hr. LED life with minimal lumen degradation. Accepts 8V to 20V input.

#### Uses:

Suitable for applications where a flush-mounted fixture is required. Ideal for walls, stairwells, and railings.

#### Dimensions:

